

BRIDGEWATER, ELEVEN-C

732 F-43 A

INCLUDING A RE-SUBDIVISION OF LOTS 467, 468, & 469 OF BRIDGEWATER ELEVEN-A, ALL BEING SITUATED IN SECTION 21, TOWNSHIP 7 NORTH, RANGE 1 EAST, CITY OF RIDGELAND, MADISON COUNTY, MISSISSIPPI

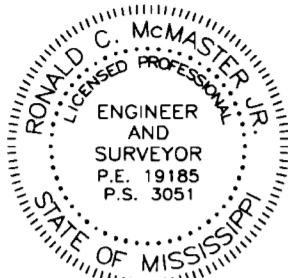

Class "B" Survey
 Bearings Based on Survey
 Grade GPS Observations
 Taken February 22, 2014
 (Geodetic North)

Our Job No. M-2227 Final Plat
 Date - October 5, 2015
 POB - Point of Beginning
 POC - Point of Commencement

● Iron Pin (1/2"x18" Iron Rebar)
 --- Easement Boundary
 (306.00) Minimum Finished Floor Elevation

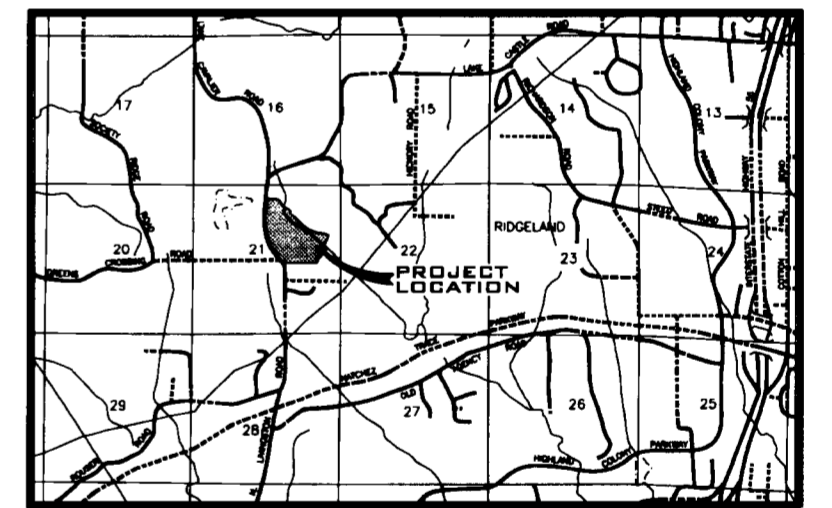
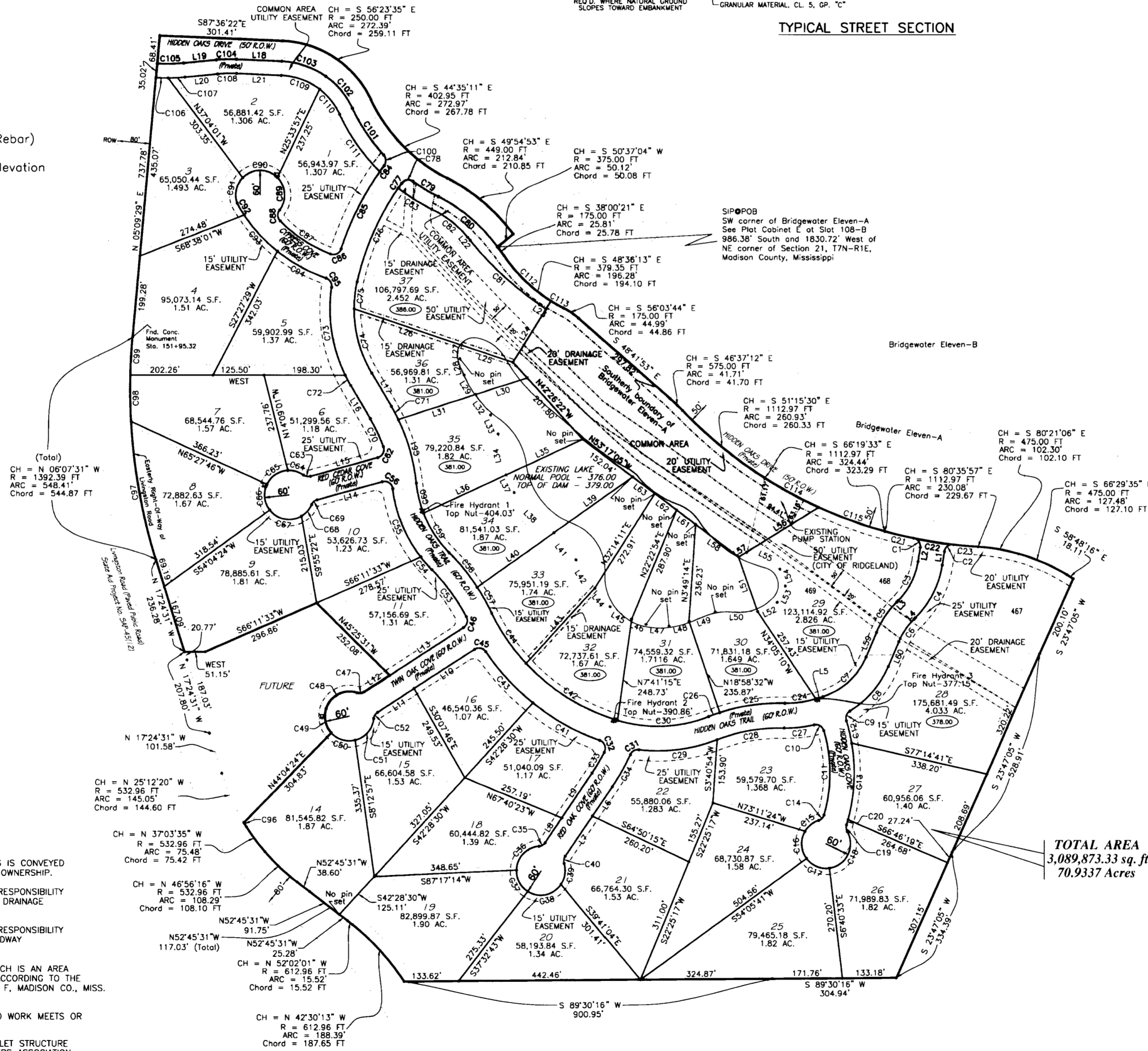
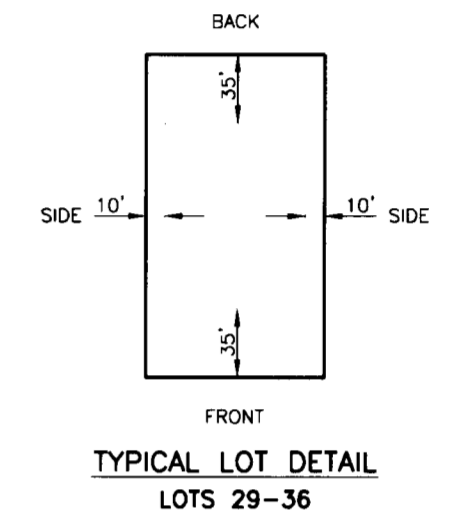
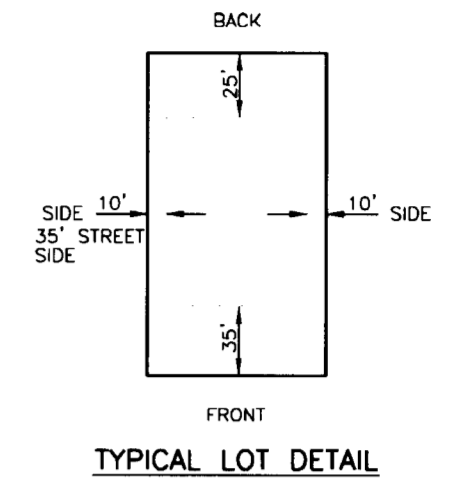
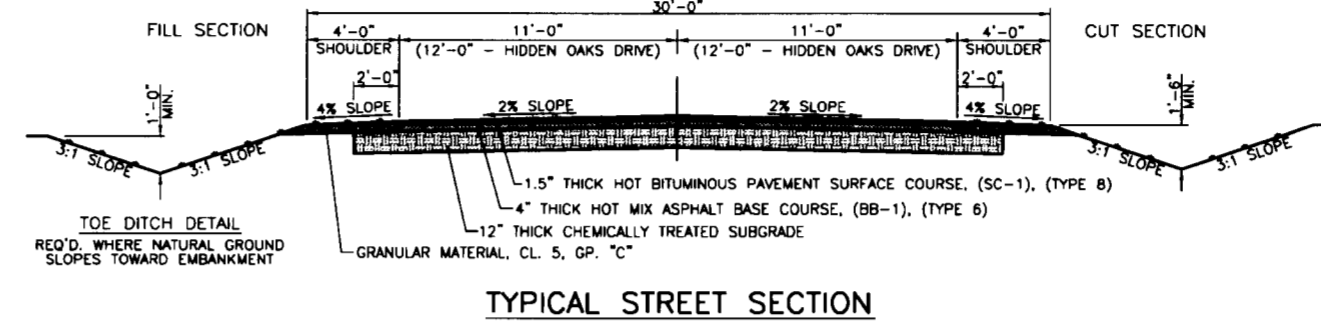
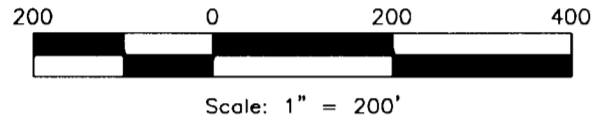

VICINITY MAP

HYDRAULIC INFORMATION

DRAINAGE AREA (PRE) - ±43.20 AC.
 DRAINAGE AREA (POST) - ±43.20 AC.
 100 YEAR RUNOFF (PRE) - 168.90 CFS
 100 YEAR RUNOFF (POST) - 190.51 CFS
 DETENTION OUTFLOW - 90.65 CFS
 DETENTION MAX. ELEV. - 377.95'

TOTAL AREA
 3,089,873.33 sq. ft
 70.9337 Acres

FIRE HYDRANT ELEVATION TABLE

FH NO.	TOP NUT ELEV.
FH 1	404.03'
FH 2	390.86'
FH 3	377.15'

- NOTES:**
- ALL STREETS AND STORM DRAINS ARE PRIVATE.
 - THE RIGHT OF OPERATION AND MAINTENANCE OF ITS UTILITIES IS CONVEYED TO THE CITY OF RIDGELAND AS SHOWN IN THE CERTIFICATE OF OWNERSHIP.
 - THE CITY OF RIDGELAND OR MADISON COUNTY ACCEPTS NO RESPONSIBILITY FOR UPKEEP, MAINTENANCE, OR FLOW OF WATER THROUGH ANY DRAINAGE EASEMENT, DRAINAGE STRUCTURE, OR WATER COURSE.
 - THE CITY OF RIDGELAND OR MADISON COUNTY ACCEPTS NO RESPONSIBILITY FOR UPKEEP, MAINTENANCE OR REPAIR OF ANY STREET OR ROADWAY PLATTED HEREON.
 - THIS PARCEL OF LAND IS SITUATED IN FLOOD ZONE "X", WHICH IS AN AREA DETERMINED TO BE OUTSIDE OF THE 500-YEAR FLOOD PLAIN, ACCORDING TO THE F.I.A. COMMUNITY PANEL NOS. 28089C0555 F AND 28089C0565 F, MADISON CO., MISS. DATED MARCH 17, 2010.
 - IRON PINS AT LOT CORNERS AS SHOWN ON THIS PLAT. FIELD WORK MEETS OR EXCEEDS THE REQUIREMENTS FOR A CLASS "B" SURVEY.
 - STREETS, DRAINAGE IMPROVEMENTS, RETENTION POND, & OUTLET STRUCTURE SHALL BE PRIVATELY OWNED & MAINTAINED BY THE HOME OWNERS ASSOCIATION.
 - DRAINAGE EASEMENTS SHALL BE PRIVATELY OWNED & MAINTAINED BY THE HOME OWNERS ASSOCIATION.
 - ALL COMMON AREA SHALL BE PRIVATELY OWNED AND MAINTAINED BY THE HOME OWNERS ASSOCIATION.

McMASTER & ASSOCIATES, INC.
 CIVIL ENGINEERS & LAND SURVEYORS

212 WATERFORD SQUARE
 SUITE 300
 MADISON, MS 39110
 601.605.1090

PROFESSIONAL LAND SURVEYOR'S CERTIFICATE
STATE OF MISSISSIPPI
COUNTY OF MADISON

I, Ronald C. McMaster, Jr., Professional Engineer and Surveyor, do hereby certify that at the request of Bridgewater, LLC, the owner, have subdivided and plotted the following described land, as follows, to-wit:

A parcel or tract of land, containing 70.9337 acres (3,089,873.33 Sq. Ft.), more or less, lying and being situated in Section 21, T7N-R1E, Madison County, Mississippi, and being more particularly described as follows:

BEGINNING at an iron pin lying at the SW corner of Bridgewater Eleven-A, as referenced on map or plot of same in Plat Cabinet E at Slot 108-B of the Records of said Madison County, Mississippi, said point being and lying 986.38' South and 1830.72' West of the NE corner of said Section 21, T7N-R1E, Madison County, Mississippi; run thence

Along the Southerly boundary of said Bridgewater Eleven-A to iron pins at each of the following calls:

25.81 feet along the arc of a 175.00 foot radius curve to the right, said arc having a 25.78 foot chord which bears South 38 degrees 00 minutes 21 seconds East; thence

196.28 feet along the arc of a 379.35 foot radius curve to the left, said arc having a 194.10 foot chord which bears South 48 degrees 36 minutes 13 seconds East; thence

44.99 feet along the arc of a 175.00 foot radius curve to the right, said arc having a 44.86 foot chord which bears South 56 degrees 03 minutes 44 seconds East; thence

South 48 degrees 41 minutes 53 seconds East for a distance of 297.82 feet to an iron pin; thence

41.71 feet along the arc of a 575.00 foot radius curve to the right, said arc having a 41.70 foot chord which bears South 46 degrees 37 minutes 12 seconds East; thence

260.93 feet along the arc of a 1,112.97 foot radius curve to the left, said arc having a 260.33 foot chord which bears South 51 degrees 15 minutes 30 seconds East to the NW corner of Lot 469 of said Bridgewater Eleven-A; thence

Leaving the Southerly boundary of said Bridgewater Eleven-A, run along the Northerly boundary of Lot 469, Lot 468 and Lot 467 of said Bridgewater Eleven-A to iron pins at each of the following calls;

324.44 feet along the arc of a 1112.97 foot radius curve to the left, said arc having a 323.29 foot chord which bears South 66 degrees 19 minutes 33 seconds East; thence

230.08 feet along the arc of a 1112.97 foot radius curve to the left, said arc having a 229.67 foot chord which bears South 80 degrees 35 minutes 57 seconds East; thence

102.30 feet along the arc of a 475.00 foot radius curve to the right, said arc having a 102.10 foot chord which bears South 80 degrees 21 minutes 06 seconds East; thence

127.48 feet along the arc of a 475.00 foot radius curve to the right, said arc having a 127.10 foot chord which bears South 66 degrees 29 minutes 35 seconds East; thence

South 58 degrees 48 minutes 16 seconds East for a distance of 18.11 feet; thence

Leaving the Northerly boundary of Lot 467 of said Bridgewater Eleven-A, run South 23 degrees 47 minutes 05 seconds West for a distance of 200.10 feet to the above referenced Southerly boundary of said Bridgewater Eleven-A, said point also lying on the Northerly boundary of the Augusta Properties, LLC property as described in Deed Book 2464 at Page 355 of the Records of said Madison County, Mississippi; thence

Leaving the Southerly boundary of said Bridgewater Eleven-A and the Northerly boundary of said Augusta Properties, LLC, run South 23 degrees 47 minutes 05 seconds West for a distance of 528.91 feet to an iron pin lying on the Northerly boundary of the Thomas W. Bobbitt property as described in Deed Book 3060 at Page 116 of the Records of said Madison County, Mississippi; thence

Leaving the Northerly boundary of said Thomas W. Bobbitt property, run South 23 degrees 47 minutes 05 seconds West for a distance of 334.39 feet to an iron pin lying on the Southerly boundary of the Tom Bobbitt property as described in Deed Book 2744 at Page 520 of the Records of said Madison County, Mississippi; thence

South 89 degrees 30 minutes 16 seconds West along the Southerly boundary of said Tom Bobbitt property, for a distance of 304.94 feet to an iron pin at the SW corner, thereof, said point also lying at the SE corner of the Walter L. Jefferson property as described in Deed Book 2535 at Page 766 of the Records of said Madison County, Mississippi; thence

South 89 degrees 30 minutes 16 seconds West along the Southerly boundary of said Walter L. Jefferson property for a distance of 900.95 feet, more or less, to the Easterly Right-Of-Way of Livingston Road (State Aid Project No. SAP-45(12)), as it existed in October, 2015; thence

Along the Easterly Right-Of-Way of said Livingston Road to iron pins at each of the following calls;

188.39 feet along the arc of a 612.96 foot radius curve to the left, said arc having a 187.65 foot chord which bears North 42 degrees 30 minutes 13 seconds West; thence

15.52 feet along the arc of a 612.96 foot radius curve to the left, said arc having a 15.52 foot chord which bears North 52 degrees 02 minutes 01 seconds West; thence

North 52 degrees 45 minutes 31 seconds West for a distance of 117.03 feet; thence

Continue North 52 degrees 45 minutes 31 seconds West for a distance of 38.60 feet; thence

108.29 feet along the arc of a 532.96 foot radius curve to the right, said arc having a 108.10 foot chord which bears North 46 degrees 56 minutes 16 seconds West; thence

75.48 feet along the arc of a 532.96 foot radius curve to the right, said arc having a 75.42 foot chord which bears North 37 degrees 03 minutes 35 seconds West; thence

11.94 feet along the arc of a 532.96 foot radius curve to the right, said arc having a 11.94 foot chord which bears North 32 degrees 21 minutes 39 seconds West; thence

North 44 degrees 04 minutes 24 seconds East for a distance of 304.83 feet to an iron pin; thence

63.01 feet along the arc of a 60.00 foot radius curve to the right, said arc having a 60.16 foot chord which bears North 12 degrees 14 minutes 15 seconds West feet to an iron pin; thence

94.76 feet along the arc of a 60.00 foot radius curve to the right, said arc having a 85.21 foot chord which bears North 63 degrees 05 minutes 32 seconds East feet to an iron pin; thence

17.91 feet along the arc of a 20.00 foot radius curve to the left, said arc having a 17.32 foot chord which bears North 82 degrees 40 minutes 36 seconds East feet to an iron pin; thence

North 57 degrees 01 minutes 04 seconds East for a distance of 74.05 feet to an iron pin; thence

North 45 degrees 25 minutes 31 seconds West for a distance of 252.08 feet to an iron pin; thence

South 66 degrees 11 minutes 33 seconds West for a distance of 296.86 feet to an iron pin; thence

West for a distance of 51.15 feet; thence

North 17 degrees 24 minutes 31 seconds West for a distance of 167.09 feet; thence

Continue North 17 degrees 24 minutes 31 seconds West for a distance of 69.19 feet; thence

548.41 feet along the arc of a 1392.39 foot radius curve to the right, said arc having a 544.87 foot chord which bears North 06 degrees 07 minutes 31 seconds West; thence

North 05 degrees 09 minutes 29 seconds East for a distance of 737.78 feet; thence

Leaving the Easterly Right-Of-Way of said Livingston Road, run to iron pins at each of the following calls;

South 87 degrees 36 minutes 22 seconds East for a distance of 301.41 feet; thence

272.39 feet along the arc of a 250.00 foot radius curve to the right, said arc having a 259.11 foot chord which bears South 56 degrees 23 minutes 35 seconds East; thence

272.97 feet along the arc of a 402.95 foot radius curve to the left, said arc having a 267.78 foot chord which bears South 44 degrees 35 minutes 11 seconds East; thence

212.84 feet along the arc of a 449.00 foot radius curve to the right, said arc having a 210.85 foot chord which bears South 49 degrees 54 minutes 53 seconds East to a point on the Westerly boundary of said Bridgewater Eleven-A; thence

Along said Westerly boundary of said Bridgewater Eleven-A, 50.12 feet along the arc of a 375.00 foot radius curve to the right, said arc having a 50.08 foot chord which bears South 50 degrees 37 minutes 04 seconds West to the POINT OF BEGINNING of the above described parcel or tract of land.

Witness my signature, this the 16th day of February, 2016.

Ronald C. McMaster, Jr.
Ronald C. McMaster, Jr., Professional Engineer and Surveyor
Mississippi P.S. No. 3051

CERTIFICATE OF COMPARISON
STATE OF MISSISSIPPI
COUNTY OF MADISON

We, Ronny Lott, Chancery Clerk and Ronald C. McMaster, Jr., Professional Engineer and Surveyor, do hereby certify that we have carefully compared this plot of BRIDGEWATER, ELEVEN-C with the original thereof, as made by Ronald C. McMaster, Jr., Professional Engineer and Surveyor, and find it to be a true and correct copy of said map or plot.

Given under my hand and seal of office this the 22 day of March, 2016.

Ronald C. McMaster, Jr. *Ronny Lott, Chancery Clerk*
Ronald C. McMaster, Jr., P.E., S.S., Professional Engineer and Surveyor
Ronny Lott, Chancery Clerk

By: *[Signature]* D.C.

FILING AND RECORDATION
STATE OF MISSISSIPPI
COUNTY OF MADISON

I, Ronny Lott, Chancery Clerk in and for said County and State, do hereby certify that the final plot of BRIDGEWATER, ELEVEN-C was filed for record in my office on this the 22 day of MARCH, 2016, and was duly recorded in Plat Cabinet E at Slot 108-B of the records of maps and plats of land in Madison County, Mississippi.

Given under my hand and seal of office this the 22 day of March, 2016.

Ronny Lott
Ronny Lott, Chancery Clerk

CITY APPROVAL CERTIFICATE
STATE OF MISSISSIPPI
CITY OF RIDGELAND
COUNTY OF MADISON

I hereby certify that this is a true copy and that this plot was approved by the Mayor and Board of Aldermen in session on the 2ND day of February, 2016.

ATTEST:

[Signature]
City Clerk
City of Ridgeland, MS
City of Ridgeland, MS

[Signature]
Mayor
City of Ridgeland

ENGINEER'S CERTIFICATE OF COMPLIANCE WITH
SUBDIVISION REGULATIONS
STATE OF MISSISSIPPI
COUNTY OF MADISON

I hereby certify that the monuments and markers shown hereon are in place on the ground and the plan and plot shown and described hereon are a true and correct representation of a survey to the accuracy designated in the Subdivision Regulations for the City of Ridgeland, Madison County, Mississippi.

WITNESS MY SIGNATURE on the 16th day of February, 2016.

Ronald C. McMaster, Jr.
Ronald C. McMaster, Jr., P.E., P.S.

BRIDGEWATER, ELEVEN-C

732 F-43B

INCLUDING A RE-SUBDIVISION OF LOTS 467,468, & 469 OF BRIDGEWATER ELEVEN-A, ALL BEING SITUATED IN SECTION 21, TOWNSHIP 7 NORTH, RANGE 1 EAST, CITY OF RIDGELAND, MADISON COUNTY, MISSISSIPPI

CERTIFICATE AND DEDICATION OF OWNER
STATE OF MISSISSIPPI
COUNTY OF MADISON

I, Barry Woodward, manager of Bridgewater, LLC, a Mississippi Limited Liability Company, do hereby certify that the aforementioned is the owner of the land described in the foregoing certificate of Ronald C. McMaster, Jr., Professional Engineer and Surveyor, and that as manager of said Bridgewater, LLC and owner, have caused the same to be subdivided and plotted as shown hereon, and hereby adopt this plot of said subdivision as the free act and deed of said limited liability company and owner, have dedicated all utilities to the public use, and have designated certain areas of land as private streets or drives intended for use by the lot owners in BRIDGEWATER, ELEVEN-C, and all other phases annexed as part of the Bridgewater II Community and subject to the Declaration of Covenants, Conditions, and Restrictions for the Bridgewater II Community applicable thereto. Any area designated as "Private Drive" or "Common Area" is not dedicated hereby for use by the general public, but is dedicated to the common use and enjoyment of the lot owners of BRIDGEWATER, ELEVEN-C as more fully provided for in the aforesaid Declaration of Covenants, Conditions, and Restrictions for the Bridgewater II Community, of record in Deed Book 2176 at Page 221, and the same being re-filed at Deed Book 2143 at Page 180, and as supplemented in Deed Book 2480 at Page 918, and any amendments or supplements thereto.

Notwithstanding anything to the contrary appearing in this Certificate or elsewhere on this plot, the undersigned does hereby grant and convey to the City of Ridgeland, or to the proper entity lawfully owning, operating, or maintaining any utility system in this subdivision, BRIDGEWATER, ELEVEN-C, a right of way and easement over, along, and across said streets or drives as shown on said plot or across any other area designated as a utility easement, for the purpose of constructing, servicing, maintaining, or repairing any of said utilities.

All utilities, utility easements, and other easements are as designated and defined hereon and in the above referenced Declaration, as the same may be amended from time to time, or as may be reserved or delineated in any conveyance by, or otherwise specified by the undersigned.

WITNESS THE SIGNATURE OF THE UNDERSIGNED, this the 16th day of Feb., 2016.

BRIDGEWATER, LLC
A Mississippi Limited Liability Company

Approved and Accepted by the Declarant
AUGUSTA 185, LLC
A Mississippi Limited Liability Company

By: *[Signature]*
Barry Woodward, Manager

By: *[Signature]*
Kirk Hamon, Manager

ACKNOWLEDGMENT
STATE OF MISSISSIPPI
COUNTY OF MADISON

Personally appeared before me, the undersigned officer in and for the jurisdiction aforesaid, the within named Barry Woodward, who acknowledged to me that he is Manager of Bridgewater, LLC, a Mississippi Limited Liability Company, who acknowledged to me that he signed and delivered this plot and the certificates thereon, for and on behalf of, said Bridgewater, LLC, as his act and deed, after being authorized so to do, and Ronald C. McMaster, Jr., Professional Engineer and Surveyor, who acknowledged to me that he signed and delivered this plot and the certificates thereon as his act and deed, on the day and year herein mentioned.

Given under my hand and seal of office this the 22 day of March, 2016.

Ronny Lott
Ronny Lott, Chancery Clerk

CITY PLANNING AND ENGINEER'S APPROVAL
STATE OF MISSISSIPPI
CITY OF RIDGELAND
COUNTY OF MADISON

We have examined this plot and find that it conforms to all conditions set forth on the preliminary plot as approved by the Mayor and Board of Aldermen and thus recommend final approval.

[Signature]
Public Works Director

[Signature]
Chairman
City Planning and Zoning Board

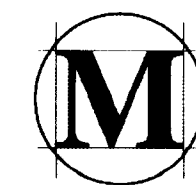
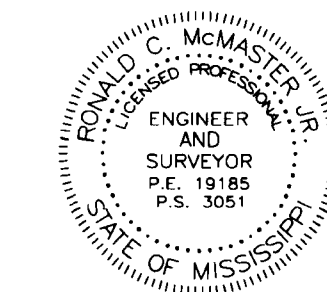

M-MASTER & ASSOCIATES, INC.
CIVIL ENGINEERS & LAND SURVEYORS

212 WATERFORD SQUARE
SUITE 300
MADISON, MS 39110
601.605.1090

BRIDGEWATER, ELEVEN-C

732 F-44A

INCLUDING A RE-SUBDIVISION OF LOTS 467,468, & 469 OF BRIDGEWATER ELEVEN-A,
 ALL BEING SITUATED IN SECTION 21, TOWNSHIP 7 NORTH, RANGE 1 EAST, CITY OF
 RIDGELAND, MADISON COUNTY, MISSISSIPPI

Parcel Line Table		
Line #	Length	Direction
L1	33.98	S8°37'48"W
L2	34.77	N8°37'48"E
L3	4.97	N45°00'10"E
L4	4.97	S45°00'10"W
L5	17.99	S72°29'48"W
L6	86.50	S33°55'08"W
L7	118.01	S33°55'08"W
L8	72.70	N33°55'08"E
L9	131.82	N33°55'08"E
L10	176.43	S57°01'04"W
L11	106.77	S57°01'04"W
L12	74.05	N57°01'04"E
L13	215.44	N57°01'04"E
L14	165.41	S74°26'30"W
L15	170.41	N74°26'30"E
L16	93.73	N30°34'05"W
L17	93.73	S30°34'05"E
L18	111.14	S87°36'22"E
L19	80.45	S84°34'25"W
L20	80.45	S84°34'25"W
L21	109.34	N87°35'50"W
L22	9.95	N38°53'36"W
L23	18.90	N55°30'40"W
L24	153.16	N31°52'24"E
L25	132.39	N71°26'05"W
L26	277.01	N71°26'05"W
L27	33.55	N6°39'56"E
L28	41.50	N14°35'16"W
L29	55.43	N31°39'12"W
L30	131.31	N72°15'39"E
L31	199.91	N72°15'39"E
L32	61.43	N35°45'49"W
L33	49.66	N22°10'21"W
L34	100.98	N11°08'16"W
L35	205.92	N65°18'56"E
L36	222.14	N65°18'56"E
L37	47.26	N24°33'26"W
L38	138.40	N45°05'47"W
L39	234.60	N54°37'59"E
L40	230.22	N54°37'59"E
L41	85.37	N39°05'05"W
L42	83.32	N33°42'40"W
L43	248.59	N42°22'16"E
L44	58.49	N40°03'39"W
L45	60.37	N59°28'54"W
L46	37.42	N70°46'37"W
L47	56.35	N85°31'03"W
L48	50.67	S75°52'32"W
L49	68.58	S70°48'08"W
L50	104.46	S89°10'59"W
L51	140.23	N19°31'46"W
L52	53.07	S65°09'06"W
L53	44.67	S26°47'58"W
L54	43.47	S18°08'44"E
L55	91.56	S63°28'15"E
L56	208.88	N58°13'43"E
L57	23.19	N58°13'43"E
L58	132.98	N53°17'05"W
L59	66.15	N22°40'58"E
L60	66.15	S22°40'58"W
L61	58.33	N53°17'05"W
L62	67.00	N53°17'05"W
L63	67.79	N53°17'05"W

Curve Table				
Curve #	Length	Radius	Chord Direction	Chord Length
C1	30.38	20.00	N34° 52' 48"W	27.54
C2	30.69	20.00	S52° 35' 26"W	27.77
C3	107.92	170.00	N26° 48' 59"E	106.12
C4	146.01	230.00	N26° 48' 59"E	143.57
C5	89.60	230.00	S33° 50' 34"W	89.03
C6	66.22	170.00	S33° 50' 34"W	65.81
C7	147.80	170.00	N47° 35' 23"E	143.19
C8	146.53	230.00	N40° 56' 00"E	144.06
C9	26.78	20.00	S20° 49' 05"W	24.83
C10	30.17	20.00	N59° 49' 26"W	27.39
C11	207.27	365.00	N0° 20' 05"W	204.50
C12	55.66	425.00	N13° 47' 45"W	55.62
C13	187.89	425.00	N2° 37' 17"E	186.37
C14	19.66	20.00	N44° 06' 03"E	18.88
C15	43.79	60.00	S51° 21' 27"W	42.83
C16	70.68	60.00	S3° 17' 53"E	66.66
C17	64.10	60.00	S67° 38' 52"E	61.09
C18	117.10	60.00	N25° 50' 05"E	99.38
C19	16.47	20.00	S6° 29' 29"E	16.01
C20	13.42	425.00	N16° 11' 28"E	13.42
C21	72.13	1112.97	S76° 32' 00"E	72.12
C22	97.38	1112.97	S80° 53' 47"E	97.35
C23	60.58	1112.97	S84° 57' 44"E	60.57
C24	77.44	235.00	N81° 56' 15"E	77.09
C25	162.87	488.00	S81° 49' 03"W	162.11
C26	29.55	488.00	S70° 31' 18"W	29.55
C27	74.26	295.00	N84° 10' 02"E	74.06
C28	168.76	428.00	S80° 04' 58"W	167.67
C29	195.53	405.22	N82° 36' 38"E	193.64
C30	226.25	345.22	N87° 33' 44"E	222.23
C31	25.06	20.00	S60° 32' 23"W	23.45
C32	34.16	20.00	N21° 50' 21"W	30.16
C33	58.93	495.00	N30° 30' 30"E	58.89
C34	89.83	555.00	N29° 16' 55"E	89.73
C35	17.91	20.00	N59° 34' 40"E	17.32
C36	87.39	60.00	S43° 30' 40"W	79.87
C37	62.15	60.00	S27° 53' 23"E	59.41
C38	93.09	60.00	N77° 59' 19"E	84.03
C39	53.35	60.00	N8° 04' 18"E	51.61
C40	17.91	20.00	S8° 15' 36"W	17.32
C41	188.60	559.57	S61° 07' 15"E	187.71
C42	267.07	499.57	S58° 20' 52"E	263.90
C43	171.03	559.57	S42° 42' 34"E	170.36
C44	149.41	499.57	S34° 27' 54"E	148.85
C45	31.08	20.00	N78° 28' 05"W	28.04
C46	29.74	20.00	N14° 25' 23"E	27.07
C47	17.91	20.00	N82° 40' 36"E	17.32
C48	94.76	60.00	N63° 05' 32"E	85.21
C49	63.01	60.00	S12° 14' 15"E	60.16
C50	64.84	60.00	S73° 16' 58"E	61.73
C51	73.37	60.00	N40° 43' 46"E	68.88
C52	17.91	20.00	S31° 21' 31"W	17.32
C53	142.82	493.44	N36° 27' 47"W	142.32
C54	41.83	345.88	S41° 17' 25"E	41.80
C55	182.72	345.88	S22° 41' 32"E	180.60
C56	34.21	20.00	N56° 33' 31"W	30.19
C57	72.86	553.44	N29° 40' 08"W	72.81
C58	109.29	553.44	N39° 05' 51"W	109.11
C59	116.01	285.88	S33° 07' 45"E	115.22
C60	75.74	285.88	S13° 54' 50"E	75.52
C61	160.60	466.37	N16° 11' 22"W	159.81
C62	32.98	20.00	N27° 11' 59"E	29.37
C63	17.91	20.00	S79° 53' 58"E	17.32
C64	40.88	60.00	N73° 45' 28"W	40.09
C65	64.14	60.00	S56° 06' 10"W	61.13
C66	66.53	60.00	S6° 17' 04"E	63.17
C67	86.39	60.00	S79° 17' 58"E	79.12
C68	38.04	60.00	N41° 17' 14"E	37.41
C69	17.91	20.00	S48° 46' 57"W	17.32
C70	74.66	406.37	N25° 18' 18"W	74.55

Curve Table				
Curve #	Length	Radius	Chord Direction	Chord Length
C71	36.74	456.37	N28° 18' 41"W	36.73
C72	28.27	367.64	S28° 21' 54"E	28.27
C73	221.48	367.64	S8° 54' 12"E	218.15
C74	164.42	307.64	S15° 15' 25"E	162.47
C75	67.09	307.64	S6° 18' 07"W	66.96
C76	250.43	651.68	S23° 33' 32"W	248.89
C77	14.95	651.68	S35° 13' 30"W	14.95
C78	31.21	20.00	S80° 34' 52"W	28.14
C79	73.08	452.95	S59° 20' 31"E	73.00
C80	191.59	399.00	N49° 42' 32"W	189.76
C81	232.03	800.00	N47° 12' 08"W	231.22
C82	105.07	240.00	N51° 26' 08"W	104.24
C83	97.81	485.00	N58° 12' 03"W	97.64
C84	18.76	711.68	S35° 52' 46"W	18.76
C85	210.09	711.68	S26° 40' 03"W	209.33
C86	32.36	20.00	N64° 33' 51"E	28.94
C87	147.60	340.82	S56° 40' 31"E	146.45
C88	28.48	20.00	S3° 28' 41"E	26.13
C89	86.44	60.00	N3° 57' 31"W	79.15
C90	94.44	60.00	S89° 40' 36"W	84.99
C91	67.14	60.00	S12° 31' 37"W	63.69
C92	33.16	400.82	S31° 33' 50"E	33.15
C93	120.47	400.82	S42° 32' 41"E	120.02
C94	136.96	400.82	S60° 56' 40"E	136.30
C95	27.61	20.00	N31° 11' 21"W	25.47
C96	11.94	532.96	S32° 21' 39"E	11.94
C97	342.21	1392.39	S10° 22' 05"E	341.34
C98	112.60	1392.39	S1° 00' 38"E	112.57
C99	93.61	1392.39	S3° 13' 55"W	93.59
C100	27.64	20.00	N2° 57' 00"W	25.49
C101	137.20	452.95	S33° 51' 26"E	136.67
C102	102.87	200.00	N39° 54' 56"W	101.74
C103	115.03	200.00	S71° 07' 43"E	113.46
C104	51.24	375.00	S88° 29' 18"W	51.20
C105	64.80	425.00	S88° 56' 31"W	64.74
C106	30.13	460.00	N88° 25' 33"W	30.13
C107	41.14	460.00	S87° 08' 08"W	41.12
C108	46.46	340.00	S88° 29' 18"W	46.42
C109	100.92	165.00	N70° 04' 30"W	99.36
C110	78.82	165.00	N38° 52' 05"W	78.07
C111	170.21	485.00	N35° 14' 02"W	169.34
C112	161.19	379.35	S45° 57' 14"E	159.98
C113	35.09	379.35	S60° 46' 36"E	35.08
C114	151.34	1112.97	S61° 52' 13"E	151.23
C115	173.09	1112.97	S70° 13' 17"E	172.92

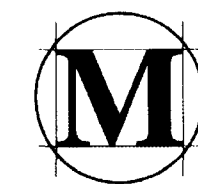

M-MASTER & ASSOCIATES, INC.
 CIVIL ENGINEERS & LAND SURVEYORS

212 WATERFORD SQUARE
 SUITE 300
 MADISON, MS 39110
 601.605.1090

BRIDGEWATER, ELEVEN-C

INCLUDING A RE-SUBDIVISION OF LOTS 467,468, & 469 OF BRIDGEWATER ELEVEN-A,
ALL BEING SITUATED IN SECTION 21, TOWNSHIP 7 NORTH, RANGE 1 EAST, CITY OF
RIDGELAND, MADISON COUNTY, MISSISSIPPI

SURVEYOR'S CERTIFICATE OF COMPLIANCE STATE OF MISSISSIPPI COUNTY OF MADISON

I, Ronald C. McMaster, Jr., Professional Engineer and Surveyor, do hereby certify that the monuments and markers shown hereon are in place on the ground and the plot and plan shown and described hereon are a true and correct representation of a survey to the accuracy designated in the subdivision regulations for Madison County, Mississippi.

Witness my signature this the 10th day of MARCH, 2016.

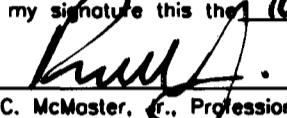
Ronald C. McMaster, Jr., Professional Engineer and Surveyor

APPROVAL OF THE BOARD OF SUPERVISORS STATE OF MISSISSIPPI COUNTY OF MADISON

I hereby certify that this is a true copy and that this plat was approved by the Board of Supervisors of Madison County in session on the 21 day of MARCH, 2016.

Madison County Board of Supervisors

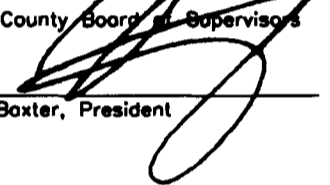
By: 
Trey Boxter, President

COUNTY ENGINEER'S RECOMMENDATION STATE OF MISSISSIPPI COUNTY OF MADISON

I have examined this plat and recommend final approval.

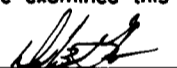
By:  3-18*
Don Gaillet, P.E.
Madison County Engineer

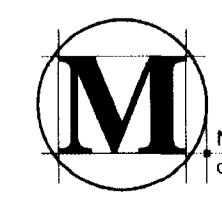
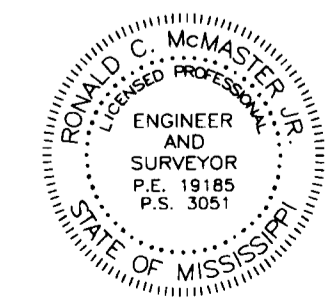

M-MASTER & ASSOCIATES, INC.
CIVIL ENGINEERS & LAND SURVEYORS

212 WATERFORD SQUARE
SUITE 300
MADISON, MS 39110
601.605.1090